



EMPOWERED LE 2024

Executive Directors' Leadership Exchange

PROGRAM

December 4 — 7, 2024

Westin Washington, D.C.
Downtown Hotel



**ALLIANCE
RELATIONS**

Cathryn Nacario, BSN-RN, PHN, MHA
Chief Executive Officer, NAMI San Diego and Imperial Counties
Board President, NAMI National

Welcome to this year's conference! I am honored to stand alongside each of you in our shared commitment to advancing mental health. I know the dedication and resilience it takes to lead in this space, and I am inspired by the strength and unity that define our NAMI community.



As we come together, let's focus on connecting, recharging, and thinking big about the future we're building together. Let's make the most of this time to learn from each other, share insights, and strengthen our vision for what's possible. Thank you for your tireless dedication and for the difference you make every single day.

Cathryn Nacario

Daniel H. Gillison, Jr
Chief Executive Officer, NAMI National

Welcome, everyone. I want to begin by sharing my deep gratitude to each of you. Every day, you take on the extraordinary responsibility of leading this mental health movement—bringing our mission to life in diverse and impactful ways across the country.

This gathering is a time to celebrate the progress we have made, strengthen our connections, and look forward to the impact we can create together. Our unity and shared purpose are what make us strong. And I hope you find inspiration, connection, and renewed energy in your time together—knowing that together we are driving real change, building resilient communities, and creating a legacy of hope and possibility.



Daniel H. Gillison, Jr

A Special Thank You To Our Working Committee Members

- Mary Kay Battaglia**, NAMI Wisconsin (Co-Chair)
- Isidro Torres**, NAMI El Paso (TX) (Co-Chair)
- Ann Ringstad**, NAMI Alaska
- Kathleen Seeberg**, NAMI Mississippi
- Susan Stearns**, NAMI New Hampshire
- Eliza Williamson**, NAMI Massachusetts
- Katie Harper**, NAMI Southwest Ohio
- Rebecca Kiessling**, NAMI Northern Virginia
- Tina Kinney**, NAMI Hernando (FL)
- Christina Matousek**, NAMI Washington County (OR)
- Freddy Morello**, NAMI Greater Orlando (FL)
- Sheel Pandya**, NAMI National
- Ashley Pollowitz**, NAMI National
- Annette Gantt**, NAMI National
- Cathryn Nacario**, NAMI National Board President
- Shirley Holloway**, NAMI National Board President Emerita

About/General Information

Registration Hours:

- 12/3: 2:00 PM – 4:00 PM
- 12/4: 7:30 AM – 9:00 AM & 5:00 PM – 8:00 PM
- 12/5: 7:00 AM – 3:20PM
- 12/6: 7:00 AM – 9:30AM



Resources and Materials

WIFI Information:

Name: Westin Conference

Passcode: EDLE2024

As you participate in the EDLE conference, we encourage you to share your experiences and insights using the hashtag **#EDLE24**. Your posts can help amplify NAMI's mission and inspire others to join the conversation on mental health advocacy and leadership.

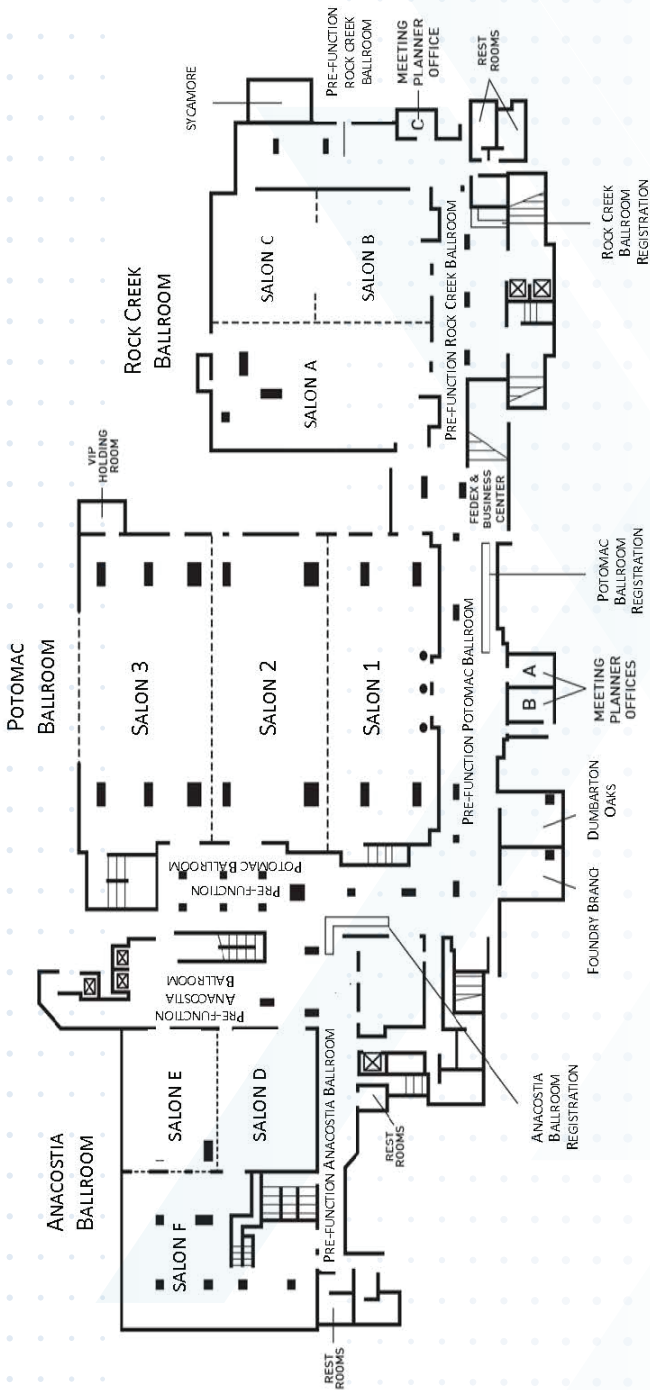

BALLROOM LEVEL

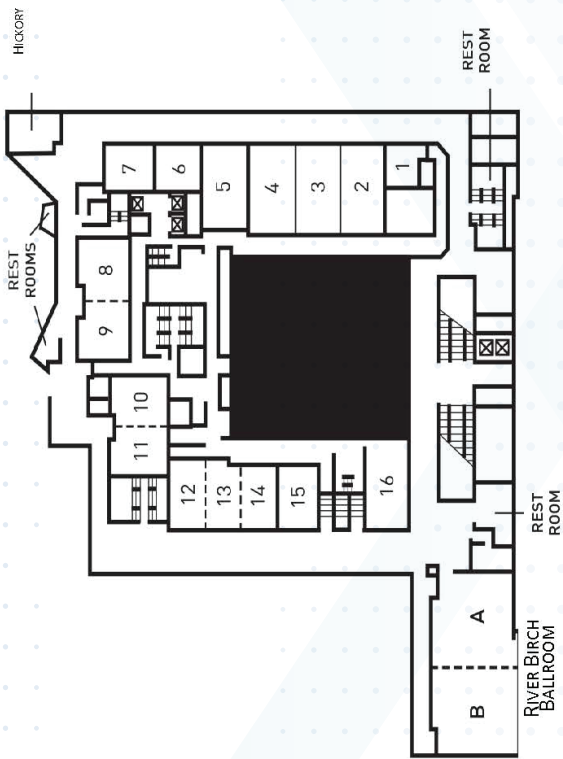

MEETING ROOM LEVEL

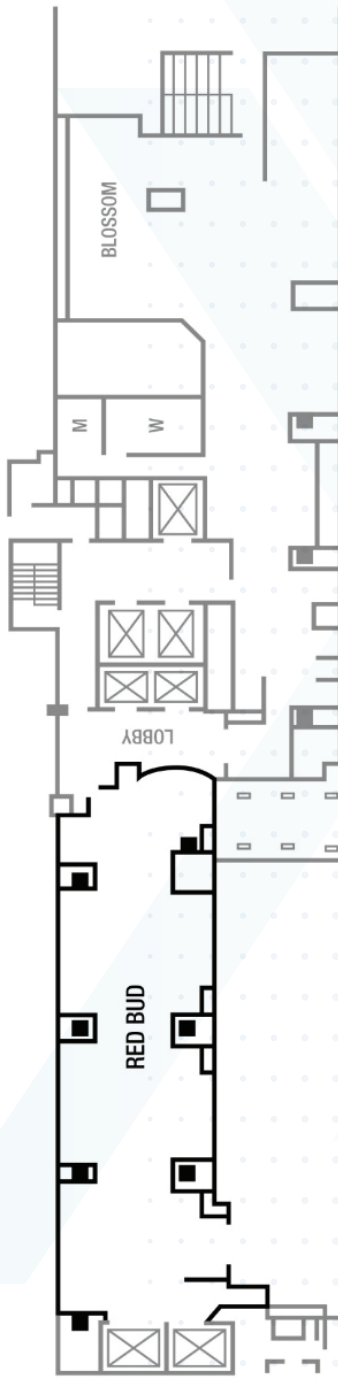

SECOND LEVEL

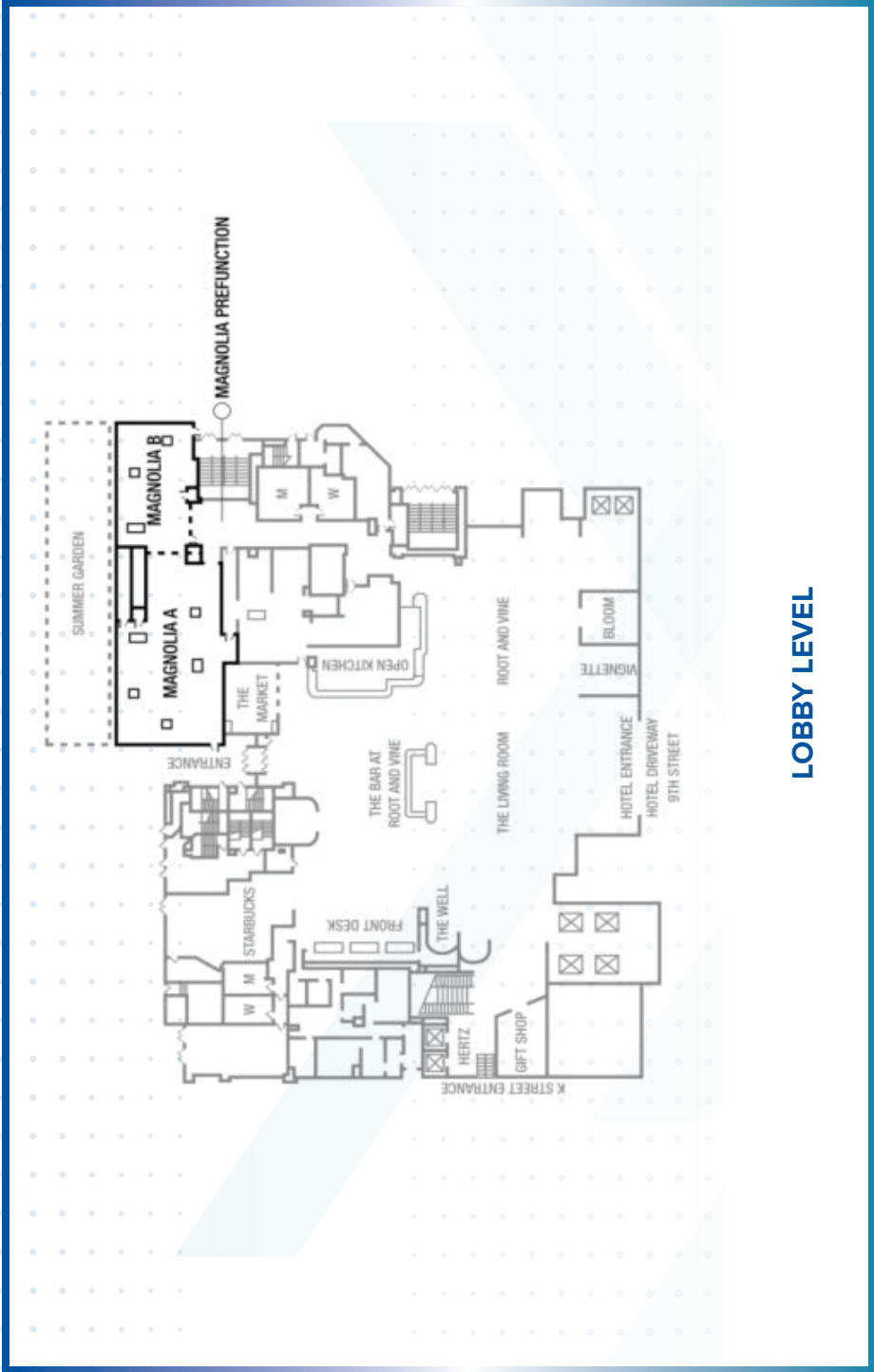

LOBBY LEVEL

Tuesday, December 3

2:00 PM – 4:00 PM

Red Bud Room

Hill Day Briefing

About: NAMI Executive Directors participating in Hill Day are encouraged to attend this in-person briefing, where NAMI National staff will dig deeper into the current state of affairs on the Hill, share more details about NAMI's top policy issues, and engage in practice meetings to prepare for Hill Day.

5:00 PM – 7:00 PM

Dirksen Senate Office Building

Hill Day Reception

About: NAMI will host a congressional reception on Capitol Hill recognizing retiring congressional leaders who have made a difference for people affected by mental illness. NAMI Executive Directors are encouraged to attend, and round-trip transportation will be provided from the EDLE hotel. Food and beverage will be provided.

Wednesday, December 4

7:30 AM – 9:00 AM

Red Bud Room

Hill Day Breakfast

About: NAMI Executive Directors attending Hill Day can pick up Hill Day schedules and materials, connect with their state delegations, and enjoy a breakfast before heading to Capitol Hill.

9:00 AM – 5:00 PM

Offsite

Capitol Hill Day (pre-registration required)

About: Legislators want to hear from their constituents. As a result, NAMI Executive Directors (EDs) are an influential and important voice in advancing mental health policy on Capitol Hill. EDs will head to the Hill on this day to urge Congress to prioritize NAMI's key mental health policy priorities.

6:00 PM – 8:00 PM

Rock Creek Ballroom Salons B&C

EDLE 2024 Opening Reception

Speakers:

Annette Gantt, Chief Field Relations Officer, NAMI National
Isidro Torres, Executive Director, NAMI El Paso & EDLE Co-Chair

About: Celebrate the opening of the Executive Directors' Leadership Exchange (EDLE) and network with fellow Executive Directors from NAMI State Organizations (NSOs) and NAMI Affiliates (NAs) across the U.S., as well as NAMI National Leadership and Staff. NAMI National staff will host information tables where Executive Directors can stop by and meet staff and ask questions. Heavy hors d'oeuvres will be served.

Thursday, December 5

7:00 AM – 8:15 AM

Rock Creek Ballroom Salon A

Breakfast

8:30 AM – 9:00 AM

Rock Creek Ballroom Salons B&C

Welcome to Day 1 of EDLE

Daniel H. Gillison, Jr., Chief Executive Officer, NAMI National

Cathryn Nacario, BSN-RN, PHN, MHA, Chief Executive Officer, NAMI San Diego and Imperial Counties & Board President, NAMI National

Mary Kay Battaglia, Executive Director, NAMI Wisconsin & EDLE Co-Chair

Sheel Pandya, National Director, Field Capacity Building, NAMI National

9:00 AM – 10:15 AM

Rock Creek Ballroom Salons B&C

NAMI's 2030 Strategic Plan – Charting the path to our 50th anniversary

Topic: NAMI's Five-Year Strategic Plan

Speakers:

Daniel H. Gillison, Jr., Chief Executive Officer, NAMI National

Cathryn Nacario, BSN-RN, PHN, MHA, Chief Executive Officer, NAMI San Diego and Imperial Counties & Board President, NAMI National

Kevin Fischer, Executive Director, NAMI Michigan

Lindsey Waldron, Partner, The Bridgespan Group

About: NAMI's new 5 year Strategic Plan was recently approved by the NAMI National Board. During this session, you'll hear from NAMI leadership and our partners at the Bridgespan group about NAMI's Alliance-wide vision for impact and theory of change as well as the strategic priorities which will guide the work of NAMI National in service of this vision. You'll also learn more about the planning process itself, field engagement, and opportunities to use this plan to support the work of your affiliate or state organization. A Q&A will follow the remarks.

Thursday, December 5

10:35 AM – 11:35 AM

4 CONCURRENT SESSIONS

Keys to Success: Essential Skills for New Executive Directors

Meeting Room 2

Topic: Organizational Capacity

Speakers:

Rebecca Kiessling, Executive Director, NAMI Northern Virginia

Ryan Crane, Executive Director, NAMI Iowa

Rachel Gearing, Senior Manager, Field Capacity Building, NAMI National

About: Stepping into the Executive Director role can be both exciting and challenging, especially in your first year. This workshop is for NAMI leaders new to their organizations and looking to build a strong foundation. We'll cover tangible skills like financial management, strategic planning, and fundraising, as well as intangible qualities like prioritization, leadership presence, and adaptability. Through expert advice, practical tools, and peer discussions, attendees will gain insights on navigating their roles, inspiring teams, and leading their organizations to achieve mission-driven goals.

Unleashing Potential: Strategic Expansion into Service Deserts

Meeting Room 3

Topic: Affiliate Development

Speakers:

Jeffrey Pirrone, Executive Director, NAMI Buffalo and Western New York

Freddy Morello, Executive Director, NAMI Greater Orlando (FL)

Liz Taylor, Executive Director, NAMI Connecticut

About: By embracing this thrilling journey, you can drive real change, inspire hope, and unlock untapped potential in underserved communities. Let's create a brighter future together! By building vibrant coalitions and uncovering community needs together, you're setting the stage for transformative impact. Let's dive in and spark change! Are you ready to make a difference?

The Path to Partnership: Corporate Collaboration for Workplace Mental Health

Meeting Room 4

Topic: Workplace Mental Health

Speakers:

Kerry Graves, Executive Director, NAMI Metro Baltimore (MD)

Jennifer Thompson, Executive Director, NAMI Maine

About: This session will share two distinct examples of building strategic partnerships with corporations, how it aligns with and impacts the mission. Each will begin with “where we started,” explain “how we grew,” and share “where we’re going.” There will be plenty of opportunity for Q&A, and a chance to hear about NAMI’s vision for how programs like these fit into their vision for Workplace programming.

NAMI Southern Nevada: A Case Study in Leveraging Tools for Marketing and Communications

Meeting Room 5

Topic: Marketing and Communications

Speakers:

Trinh Dang-Mai, Executive Director, NAMI Southern Nevada

About: Learn about how NAMI Southern Nevada uses digital marketing tools like Constant Contact, Eventbrite, Canva, and text marketing to enhance outreach and communication. Learn Take away practical tips for leveraging these platforms to promote events, engage communities, and spread awareness effectively. Plus, hear from the National Marketing & Communications team as they provide an overview of resources and tools available to NAMIs, including templates and strategies to support local efforts. This session offers valuable insights to EDs new to this space to elevate their outreach

Thursday, December 5

12:00 PM – 1:30 PM

Rock Creek Ballroom Salon A

Networking Lunch

About: We will have tables set up for informal networking, meeting, and catching up with colleagues, as well as some tables labelled by topic if EDs are interested in participating in topical discussions. The NAMI Board Executive Committee and Field Resource Development team (NAMIWalks and NAMI Do It Your Way) will also have tables set up for networking.

1:50 PM – 2:50 PM

4 CONCURRENT SESSIONS

Adapting NAMI Signature Programs to Support Communities in Need

Meeting Room 2

Topic: Programming Development & Management (NAMI Signature and Non-Signature Programs)

Speakers:

Gigi Crowder, Executive Director, NAMI Contra Costa (CA)

Dave Hunt, Executive Director, NAMI Clackamas County (OR)

Mallory Kloucek, Manager, National Education Program, NAMI National

About: NAMI's signature programs offer vital mental health resources, but adapting them for diverse ethnic and cultural communities can increase their impact. This workshop explores strategies to customize NAMI programs for greater inclusion, helping underserved populations facing cultural, socioeconomic, and geographical barriers. Participants will learn from case studies; share best practices; and discuss enhancing accessibility, cultural relevance, and program effectiveness. Join us to ensure your mental health initiatives resonate within the communities you serve, fostering inclusion and support where it's needed most.

Strategic Planning: Uncovering Your Guiding Light and Mapping Your Path to Excellence

Meeting Room 3

Topic: Organizational Capacity

Speakers:

Jennifer Jennette, Executive Director, NAMI Marion & Crawford Counties

Sharon Horton, Executive Director, NAMI New York State

Ashley Pollowitz, Senior Manager, Field Capacity Building, NAMI National

About: Strategic planning is a foundation for any successful organization. However, the process can be intimidating and overwhelming. In this session, we will discuss the importance of developing a mission-driven strategic plan, the role of the Executive Director in strategic planning, and how to ensure accountability and follow up. Additionally, we will share strategies and tools that Executive Directors of organizations of all sizes and capacities can use throughout the process.

So You Want to be a Lobbyist?

Meeting Room 4

Topic: Advocacy & Public Policy

Speakers:

Colleen Thayer, Executive Director, NAMI Sarasota and Manatee Counties (FL)

Ray Merenstein, Executive Director, NAMI Colorado

Hannah Wesolowski, Chief Advocacy Officer, NAMI National

About: Join the mental health advocacy movement! Connect with NAMI experts to discover powerful strategies for state-level change. Collaborate with local organizations and share personal stories that resonate. Equip yourself with training, advocacy toolkits, and legislative resources. Mobilize your community. Celebrate successes, network with passionate advocates, and stay motivated with ongoing support. Let's prioritize mental health together—your voice matters! Are you ready to take action?

Thursday, December 5

NAMI TraumaInSight: A New Resource for Your Community

Meeting Room 5

Topic: Youth & Young Adult Mental Health Programming

Speaker:

Barb Solish, National Director, Office of Innovation, NAMI National

About: NAMI TraumaInSight is designed to bridge the gap in training opportunities on trauma awareness that are currently available to youth serving professionals. NAMI TraumaInSight introduces youth serving professionals to key topics in trauma awareness, such as the impact of traumatic stress on behavior across the developmental lifespan, as well as resilience building strategies that help to buffer against the effects of traumatic stress, for both the youth and the professionals who serve them. In this session, we will explore NAMI TraumaInSight and how Executive Directors can bring the program to their communities.

3:10 PM – 4:10 PM

4 CONCURRENT SESSIONS

Building a Sustainable Future: Starting from the Ground Up

Meeting Room 2

Topic: Fundraising & Fund Development

Speakers:

Chris Bouneff, Executive Director, NAMI Oregon

Katie Harper, Executive Director, NAMI Southwest Ohio

About: Learn strategies that other NAMIs have used to secure funding to help sustain and grow, including grant writing, individual giving, corporate partnerships, and event planning. Gain practical tips and tools to diversify your revenue streams and build long-lasting relationships with donors.

No Fear in Hiring Peers: Supporting People in Recovery in the Workplace Meeting Room 3

Topic: Human Resources

Speakers:

Tina Kinney, Executive Director, NAMI Hernando (FL)

Christina Matousek, Executive Director, NAMI Washington County (OR)

Annie Schmidt, Senior Manager, Field Capacity Building, NAMI National

About: This session will focus on the importance of hiring peers within our organizations. We will explore methods of how to create a supportive environment within the workspace along with sharing examples of personal experiences.

Building Strong Boards: Strategies for Recruitment, Retention, and Engagement Meeting Room 4

Topic: Governance & Membership

Speakers:

Erin Ryan, Executive Director, NAMI Westside Los Angeles (CA)

Ann Ringstad, Executive Director, NAMI Alaska

Shirley Halloway, PhD, President Emerita, NAMI National Board & President Emerita, NAMI Alaska

About: A strong board is crucial to any nonprofit's success. In this panel, nonprofit leaders and governance experts will share best practices for board management, from recruiting diverse members to retaining and engaging them effectively. Learn how to identify candidates aligned with your mission, foster long-term commitment, and keep board members engaged with your organization's goals. Attendees will leave with actionable strategies to enhance board performance and build a dynamic leadership team that drives lasting impact.

Thursday, December 5

Clarifying Roles Across the Alliance

Meeting Room 5

Topic: Governance & Membership

Speakers:

Isidro Torres, Executive Director, NAMI El Paso (TX)

Lorna Palmer, Executive Director, NAMI Oklahoma

Lindsey Waldron, Partner, The Bridgespan Group

About: We want to hear from you! Join us for a look at the current state of NAMI's Standards of Excellence and discuss the upcoming steps to clarify and update them. Members of the Strengthen the Alliance Workgroup, Bridgespan, and NAMI Field Governance will set the stage for small group listening sessions to share your input – this is just one opportunity to share your thoughts; more to come! Breakout groups will share key challenges, points of tension, and other thoughts on topics such as accountability and governance; programs; advocacy; data collection and reporting; fundraising; and diversity, equity, and inclusion”.

4:30 PM – 4:45 PM

Rock Creek Ballroom Salons B&C

Day 1 Closing

Speaker:

Sheel Pandya, National Director, Field Capacity Building, NAMI National

5:00 PM – 7:00 PM

River Birch Ballroom

Executive Director Gift Exchange

Please Note: Dinner is on your own after the gift exchange

About: This fun activity is a tradition at EDLE. Join your fellow EDs to exchange (and maybe even steal!) gifts. If you plan to participate, keep the following in mind:

- Bring one gift per person.
- The value of the gift should not exceed \$15.
- All gifts should be good-natured, humorous, poignant, or uplifting.
- Gifts that highlight your geographic location or promote self-care are especially welcome!

Friday, December 6

7:00 AM – 8:00 AM

Rock Creek Ballroom Salon A

Breakfast

8:10 AM – 9:10 AM

Rock Creek Ballroom Salons B&C

Keynote Speech

Speaker:

April Simpkins, NAMI National Ambassador

About: Join us for an engaging session with NAMI Ambassador, April Simpkins. April is a Mental Health Advocate, National Speaker, New York Times Best Selling Author, a seasoned Human Resources Executive with 30 years of experience, and currently serving as Chief Human Resources Officer at Questco. She has supported over 1,000 businesses in optimizing their human capital and is a passionate mental health advocate. After the passing of her daughter, Cheslie Kryst, Miss USA 2019, April became a NAMI Ambassador. She coauthored the New York Times Best Seller, “By The Time You Read This: The Space Between Cheslie’s Smile and Mental Illness,” sharing Cheslie’s story to emphasize the importance of mental health. April is certified in Mental Health First Aid and Emotional CPR, and she continues to inspire leaders nationwide through her speaking engagements.

9:25 AM – 10:25 AM

4 CONCURRENT SESSIONS

Building Inclusive Communities with the NAMI Sharing Hope Initiative Meeting Room 2

Topic: Diversity, Equity, and Inclusion

Speakers:

Dawn Brown, Director, Cross Cultural Innovation & Engagement Task Force, NAMI National

Kyle Galimba, Manager, Asian American Native Hawaiian Pacific Islander, Cross Cultural Innovation & Engagement Task Force

Charu Aggarwal, Lead Consultant, NAMI Chai and Chat

Yolonda Kelsor, Lead Consultant, NAMI Sharing Hope

About: This workshop is an introduction to the NAMI Sharing Hope Series—a suite of community-centered initiatives promoting mental health awareness in Black/African Ancestry, Hispanic, Filipino, and South Asian communities through storytelling and dialogue.

Understanding Bookkeeping for the 25%/75% Split Goal

Meeting Room 3

Topic: Financial Management

Speakers:

Lauren Simonds, Executive Director, NAMI Washington

About: Do you know if you have overhead expenses that could be program expenses? Are you struggling to reach the “golden 25%/75% split” in your expenses to qualify for corporate giving programs? This session will focus on developing and utilizing a “class” system in your bookkeeping, regardless of the platform you are using.

Building Clarity & Access: Tech Updates from InfoSys

Meeting Room 4

Topic: Information Systems/Technology (360/720)

Speakers:

Sarah Hines, National Director, Information Systems, NAMI National

Kayla Camacho, Software Developer, NAMI National

About: Join the InfoSys team for an update on our tech strategy to enhance transparency, streamline access, and reduce bottlenecks across NAMI systems. We'll share recent advancements, including improvements in 720 and new dashboards for affiliate insights. Looking ahead, we'll share the next steps towards a unified experience (MyNAMI) with simplified logins and improved usability which will reduce affiliate blockers to work more efficiently and get the information they need. Get a preview about how upcoming changes to National's technical systems in 2025 will improve your affiliate's experience.

Friday, December 6

Leading by Example: Cultivating Work-Life Balance for Yourself and Your Team

Meeting Room 5

Topic: Workplace Mental Health

Speakers:

Holly Doggett, Executive Director, NAMI North Carolina

Chris Michaels, Executive Director, NAMI Keystone Pennsylvania

About: As a leader, your actions set the tone for your team's culture. This workshop will explore how to model healthy work-life balance, empowering your team to prioritize their well-being. Learn strategies for setting boundaries, delegating effectively, and creating a supportive work environment. Discover techniques to enhance your work-life balance, boost your resilience, and lead with greater energy and focus. By prioritizing your own self-care, you can inspire your team to achieve greater work-life harmony.

10:40 AM – 11:40 AM

4 CONCURRENT SESSIONS

Grant Writing and Management for NAMIs of All Sizes

Meeting Room 2

Topic: Fundraising & Fund Development

Speakers:

Eliza Williamson, Executive Director, NAMI Massachusetts

Nick Macrini, Executive Director, NAMI Virginia

About: Learn the art and science of securing grant funding to support your NAMI's goals. This workshop will cover essential grant writing techniques, from identifying potential funders to crafting compelling proposals. You'll also learn how to effectively manage grants, track expenses, and report on outcomes. Gain practical tools and strategies to increase your chances of grant success and maximize the impact of your NAMI's work.

Telling Your Story: Developing and Using Data Management Strategies to Maximize Impact

Meeting Room 3

Topic: Program Development & Management

Speakers:

Susan Stearns, Executive Director, NAMI New Hampshire

Zahira Correa, Manager, Research, NAMI National

Julie Gomez, Executive Director, NAMI Greater Wheeling (WV)

About: Whether you have current data tools or need to create a new system, our session will help you learn how to gather and use data for your programming, development, and advocacy for your state or affiliate.

Tools, Technology, and Innovation to Support and Increase Affiliate Operational Efficiencies

Meeting Room 4

Topic: Affiliate Development

Speakers:

Susan Holtzman, Executive Director, NAMI Miami-Dade County (FL)

Mary Kay Battaglia, Executive Director, NAMI Wisconsin

Renata Ponichtera, Director, Affiliate Development, NAMI National

About: This session will explain nonprofit operations. A NAMI Affiliate will explain and share technological tools used to increase efficiency, and a NAMI State Organization will explain and share operational templates and methods for making them available to affiliates. NAMI National will provide an overview of tools and resources to guide nonprofit operations.

Fireside Chat with Dr. Crawford: Exploring Strategies for Engaging Parents in Youth Mental Health

Meeting Room 5

Topic: Youth & Young Adult Mental Health Programming

Speakers:

Dr. Christine Crawford, Associate Medical Director, NAMI National

About: This session will provide an opportunity to hear from Dr Crawford, in an informal setting, on the topic of how to start conversations with parents regarding children's mental health.

11:55 PM – 12:55 PM

Rock Creek Ballroom Salon A

Networking Lunch & Dr. Christine Crawford Book Signing

About: Join us for a networking lunch and book signing with Dr. Christine Crawford!

As the author of NAMI's second book, "You Are Not Alone for Parents and Caregivers: The NAMI Guide to Navigating Your Child's Mental Health," Dr. Crawford provides a resource for every trusted adult helping a child or young adult manage their mental health.

You will be able to purchase books onsite. If you already own a copy, please bring it with you. Please note: if purchasing a book onsite, we can only accept credit card.

We will also have tables set up for informal networking, meeting, and catching up with colleagues, as well as some tables labelled by topic if EDs are interested in participating in topical discussions. The NAMI Board Executive Committee and Field Resource Development team (NAMIWalks and NAMI Do It Your Way) will also have tables set up for networking.

1:00PM – 2:00 PM

The Election is Over. What's Next?

Rock Creek Ballroom Salons B&C

Speakers:

Hannah Wesolowski, Chief Advocacy Officer, NAMI National
Sue Abderholden, Executive Director, NAMI Minnesota

About: Hear the outlook for key NAMI policy priorities going into 2025 and what the election results mean for federal, state, and local advocacy. Join us to discuss how we can engage grassroots advocates and elected officials in the year ahead to improve the lives of people affected by mental health conditions.

2:15 PM – 3:15 PM

4 CONCURRENT SESSIONS

Aligning the Alliance: The National Board's Commitment to the Field Meeting Room 2

Topic: NAMI National Board

Speakers:

Cathryn Nacario, BSN-RN, PHN, MHA, Chief Executive Officer, NAMI San Diego and Imperial Counties & Board President, NAMI National

Shirley Holloway, PhD, NAMI National Board Executive Committee

Joseph Gatto, JD, NAMI National Board Executive Committee

Pooja Mehta, MPH, NAMI National Board Executive Committee

Jeff Fladen, MSW, NAMI National Board Executive Committee

Amy Brinkley, CRS/CHW, CAPRCII, NAMI National Board Executive Committee

Joyce A. Campbell, JD, NAMI National Board Executive Committee

About: Are you interested in learning more about the NAMI National Board and its role within the NAMI Alliance? Do you have a question that you've been wanting to ask the Board, but haven't found the right moment? If you answered yes to one or both questions, this session is for you! During this session, you will have an opportunity to meet the Board's Executive Committee members; hear about the Board's structure, responsibilities, Advisory Councils, Committees, and Work Groups; ask questions; and share your ideas on how we can build bridges across the Alliance.

Policies with Purpose – Aligning HR Practices with Organizational Goals Meeting Room 3

Topic: Human Resources

Speakers:

Katie Jenkins, Executive Director, NAMI Greater Cleveland (OH)

Kim Jones, Executive Director, NAMI Georgia

About: Explore key human resource management practices tailored to NAMI's unique needs at the state and local levels. Experienced Executive Directors will share proven strategies for both internal and external HR management. Participants will learn how to apply HR practices fostering a positive, inclusive culture for employees, in alignment with NAMI's values. Gain insights into enhancing performance management and employee engagement through innovative policies. Ideal for leaders seeking actionable plans for strengthening human resource processes, this interactive session also provides discussion and Q&A opportunities.

Breaking Barriers: Criminal Justice Reform and Jail Diversion for Mental Health and Substance Use Disorders

Meeting Room 4

Topic: Advocacy & Public Policy

Speakers:

Barbara Thompson, Executive Director, NAMI Indiana

Mary-Francis Walsh, Executive Director, NAMI Sonoma County (CA)

Shannon Scully, Director, Justice Policy & Initiatives, NAMI National

About: This session will explore the critical role of NAMI organizations at local, state, and federal levels in advancing criminal justice reform for individuals with mental health and substance use disorders. We will highlight successful initiatives and collaborative efforts that aim to divert individuals from the criminal justice system, ensuring they receive the support they need. Join us to learn how these vital efforts are reshaping the intersection of mental health, substance use, and the criminal justice system, paving the way for a more compassionate and effective approach to justice.

Fostering Faith Partnerships: Building Strong Relationships in the Faith Community

Meeting Room 5

Topic: Diversity, Equity, and Inclusion

Speakers:

Doug Beach, Executive Director, NAMI Greater San Antonio (TX)

Carali McLean, Executive Director, NAMI Florida

Dr. Cynthia McKnight, FaithNet Manager, NAMI National

About: Engaging with faith communities can greatly enhance your organization's impact. This workshop will guide NAMI leaders on building strong relationships with faith-based organizations to advance shared mental health and community well-being goals. We'll discuss innovative programs, communication strategies, and using tools like NAMI FaithNet to foster collaboration. Learn how to create partnerships rooted in trust, mutual support, and cultural sensitivity. Attendees will leave with practical ideas to strengthen ties with faith communities and expand their organization's influence.

Friday, December 6

3:30 PM – 4:45 PM

Meeting Room 2

NAMI State Organization Breakout

About: Executive Directors from NSOs will convene and discuss relevant topics. **Mary Kay Battaglia**, Executive Director, NAMI Wisconsin and EDLE Co-Chair will facilitate this discussion.

3:30 PM – 4:45 PM

Rock Creek Ballroom Salons B&C

NAMI Affiliate Breakout

About: Executive Directors from NAs will convene and discuss relevant topics. **Isidro Torres**, Executive Director, NAMI El Paso and EDLE Co-Chair will facilitate this discussion.

5:30 PM – 7:30 PM

River Birch Ballroom

Dinner Hosted by NAMI National for Executive Directors

About: Let's come together and celebrate EDLE 2024 over a lively dinner. It's a great opportunity for EDs to network with each other and with NAMI National leadership and staff over a meal and merriment.

RVSP Required in Advance.

Saturday, December 7

8:00 AM – 11:00 AM

River Birch Ballroom

Breakfast (To-Go Breakfast Available)

Thank you for attending EDLE 2024!

EMPOWERED LE 2024

Use #EDLE24 to post on
your social media platforms

www.nami.org



@NAMICommunicate



@NAMICommunicate



@NAMI



@NAMI



@NAMI



@NAMICommunicate



nami

National Alliance on Mental Illness



NEUROCRINE[®]
BIOSCIENCES

**ALLIANCE
RELATIONS**